

## Double-Ended Beam Load Cell

### FEATURES

- Capacities: 10k to 125k lbs
- Environmental protection: IP67 (DIN 40.050)
- Material: Stainless steel
- Certified by NTEP class III, 10000 divisions
- **Optional**
  - FM certified for use in potentially explosive atmosphere

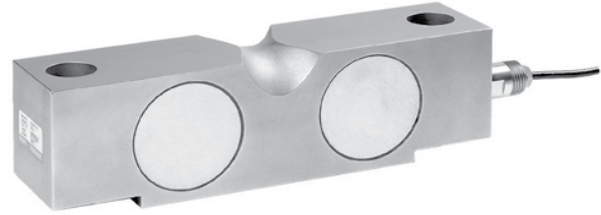

### APPLICATIONS

- Silos, tanks and hoppers
- Weighbridges

### DESCRIPTION

The 9303 is a link-loaded stainless steel double-ended shear beam type load cell, specifically designed for truck scales, track scales and high capacity weighing applications.

A reliable sealing and mechanical protection of the strain gage area is ensured by the use of potting compound with a metal cover.

This load cell is rated intrinsically safe by the FM system, making it suitable for use in potentially explosive atmospheres.

### OUTLINE DIMENSIONS in inches

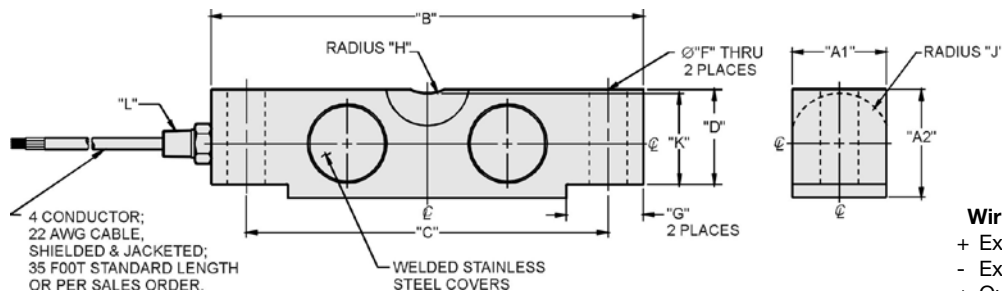

**Wiring**

+ Excitation	Red
- Excitation	Black
+ Output	Green
- Output	White

CAPACITY	A <sub>1</sub>	A <sub>2</sub>	B	C	D	F	G	H	J	K	L
10k-25k	1.69	1.94	7.75	6.50	1.70	0.68	1.38	0.75	0.90	1.63	1/4-18 NPT
40k	1.94	2.44	10.25	8.50	2.10	0.81	1.93	1.00	1.12	2.00	1/4-18 NPT
50k-125k	2.44	2.94	10.25	8.50	2.65	1.06	1.93	1.00	1.37	2.54	1/2-14 NPT

Capacities are in pounds.

## Double-Ended Beam Load Cell

SPECIFICATIONS			
PARAMETER	VALUE		UNIT
Standard capacities ( $E_{max}$ )	10k, 15k, 20k, 25k, 30k, 40k, 50k, 60k, 75k, 125k <sup>(1)</sup>		lbs
Accuracy class according to NTEP	NTEP III L	Non-Approved	
Maximum no. of verification intervals ( $n_{IC}$ )	10000		
Rated output (=S)	3		mV/V
Rated output tolerance	0.0075		±% mV/V
Zero balance	1.0		±% FSO
Combined error	0.0200	0.0300	±% FSO
Temperature effect on zero	0.0010	0.0015	±% FSO/5°C (°F)
Temperature effect on output	0.0008	0.0008	±% FSO/5°C (°F)
Compensated temperature range	-10 to +40 (+14 to 104)		°C (°F)
Operating temperature range	-18 to +65 (0 to +150)		°C (°F)
Safe load limit	150		% $E_{max}$
Ultimate load	300		% $E_{max}$
Safe side load limit	100		% $E_{max}$
Excitation voltage recommended	10		V
Excitation voltage maximum	15		V
Input resistance	700±14		Ω
Output resistance	697±4		Ω
Insulation resistance	≥1000		MΩ
Environmental protection	IP67		
Element material	Stainless steel		

<sup>(1)</sup> 10K is not approved by NTEP

FSO—Full Scale Output

**Mounting:**

Correct mounting of the load cells is essential to ensure optimum accuracy and performance. Further information is available upon request. No mounts available for 9303.

All specifications subject to change without notice.